

# This Old House

**Avoid  
the rip-off!**

Mattress  
buying guide  
p.60

## Add Old-House Charm

**48**  
amazing  
ideas  
to steal

**BRILLIANT  
LIGHTING  
DESIGN TIPS**

**12**  
bamboo  
floors  
with that  
hardwood  
look

**CLOSET and  
BOOKCASE  
BUILT-INS**

> Ideas > Tips > Plans

JANUARY/FEBRUARY 2016  
THISOLDHOUSE.COM

\$4.99US \$5.99CAN



0 70992 10160 3



## Upsized and unified

A spare bedroom turned dressing area offers a spot for a new master bath with an old-house vibe

BY NINA MALKIN • PHOTOGRAPHS BY ALEX HAYDEN

→ **HISTORIC CHARM** often ends at the bathroom door. It certainly did at Roger Nyhus's 1906 home in Seattle, where the bath was a showerless space with, as he says, "only enough storage for a toothbrush." What he craved instead was "a spa-like sanctuary where I could get centered in the morning and wash away stress at the end of the day." And while Roger wanted to respect the house's history, he didn't want to compromise on features like a large tub and a separate shower.

Designers Mike Freeman and Kim Clements found space to spare by converting the existing master bath into a walk-in closet and commandeering an approximately 15-foot-square bedroom turned dressing area for the new bath. Working around a large window, they placed a double vanity and a shower on one wall perpendicular to it, and a freestanding tub and enclosed commode opposite them. A deep soffit above the sinks creates an alcove effect, and tile "rugs" divide the room into stations. "The tile rugs make it especially homey," Roger says. "I've never walked in and felt it was too big. It fits me perfectly."



BEFORE

**BEFORE** A spare room leading to the master suite served as a makeshift dressing area.

**AFTER** Basketweave tile with broad borders forms "rugs" that carve out different areas in the large bath. Custom cabinets provide ample storage. Paint (cabinet): Farrow & Ball Green No. 75



• **before + after:**  
bath design



**homeowner tip**

ROGER NYHUS, SEATTLE  
“Putting a dimmer switch on every light is important in a bath. If you get up at 3 A.M. you don’t want to have glaring light.”



Perforated-metal door panels on the built-in linen cabinet let you see what’s inside, and keep sheets and towels aerated.



The wainscot cap alongside the tub is extra-deep to form a shelf for candles, cocktails, and other necessities.  
Tub: Waterworks.  
Tub filler: Hansgrohe

**MORE VINTAGE INSPIRATION**  
Find additional ideas for creating a period-look bath at [thisoldhouse.com/janfeb2016](http://thisoldhouse.com/janfeb2016)

**after**

The thoroughly modern new bath features separate bathing, grooming, and lavatory areas, as well as ample natural light.

**before**  
Doors to the sitting room and the bath dated to when the home served as a boardinghouse.

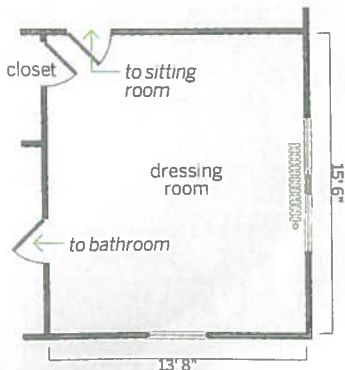

1. Closed up two doors to create a large shower with a frameless glass enclosure.

2. Added a pocket door leading to the rest of the master suite to eliminate a door swing.

3. Built an enclosed water closet, fitted with toilet, bidet, and corner sink.

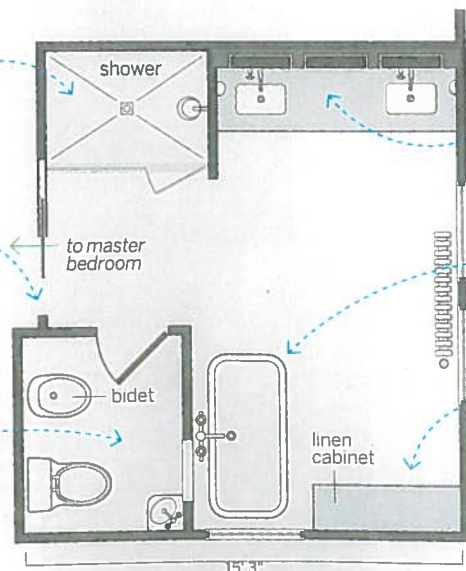

4. Placed an 8-foot double vanity with three medicine cabinets to the left of the large window.

5. Installed a freestanding tub near the other window for natural light.

6. Put a wainscot-high linen cabinet in the corner opposite the sinks.