

Before & after kitchens AND BATHS™

**SPEND
WISELY!**
10 WAYS
TO REMODEL
FOR LESS p. 8

try this
Install a tile
backsplash in a
weekend p. 26

2016
BHG.COM

BHG specials

0 114005 14048 7

Display until April 4

6 1

\$9.99 U.S.

24 INSPIRING UPDATES
**Small-Space Solutions
That Really Work**
TOP APPLIANCE PICKS
—AND WHY WE LOVE THEM



focus on finishes

Large-format 12×24-inch tiles minimize grout lines in the handsome, dark basalt stone flooring for a clean look that doesn't overwhelm the subtle patterns of shiplap and subway tiles on the walls. Homeowner Monica Garner loves soaking in the new freestanding tub to contemplate the breathtaking view and the whimsical star fixture overhead.



BEFORE

Bright Outlook

Surface updates, smart storage, and a soothing palette give a 1980s bath a fresh perspective.

writer Jan Soultis Walker **photographer** John Granen **field editor** Linda Humphrey



who

A couple with two teenage daughters

where

Bellevue, Washington

what

A misplaced walk-in closet and a bulky built-in tub prompted Curtis and Monica Garner to renovate their 1980s-era master bathroom. Designer Kim Clements of JAS Design/Build merged a portion of the closet with the bath, replacing it with a stylish built-in storage cabinet and bench. New surfaces—subway tiles, shiplap walls, painted cabinetry, and a granite countertop, all in muted gray—“make the room feel soft and not stark,” Monica says. Although the original marble floor tiles were pretty, they didn’t give the Garners the fresh, crisp look they wanted. So Clements replaced the flooring with dark basalt stone tile, which anchors the room’s light, bright elements. Trading the clunky built-in tub for a shapely freestanding model and adding a long vanity—open beneath to keep the look airy—made the room feel larger. “We love this bath so much,” Monica says. “It’s has a great vibe for getting ready every morning.”

FOR RESOURCES, SEE PAGE 90.

KEY FEATURES

1 The new vanity, tucked neatly between the shower on the left and a toilet compartment on the right, uses a single column of drawers and separate (but adjoining) medicine cabinets above to boost storage and define Monica’s and Curtis’s personal spaces.

2 The shower gained privacy with a new subway-tile enclosure. Vintage-style fixtures, including a handshower rail, complement the room’s old-meets-new aesthetic.

3 Built-in cabinets and a matching bench are topped with walnut for a warm, rustic accent. The cabinets occupy a portion of the former walk-in closet space and include designated space for Monica’s hair dryer just steps from the vanity.



CUSTOMIZE YOUR LIGHTING PLAN

Your bathroom lighting should work hard so you don't have to. Take the guesswork out of planning with these tips.

Layer it. Ambient lighting is the foundation of a good lighting plan. It brightens the overall space and lets you move about safely. Task lighting illuminates the specific activities you do most, from shaving to showering. Accent lighting highlights particular elements of the bath that you want to show off, such as intricate tilework or a beautiful glass bowl sink.

Follow the rules. Electrical code requires that the bottom of a chandelier be at least 8 feet from the top of a tub or tub surround.

Address your needs. To boost energy savings, install motion sensors with your fixtures—they detect movement and turn lights on and off as needed. Also, consider installing a dimmer, which allows you to adjust the amount of light to set the mood from relaxing to energizing.

the plan

Relocating the walk-in closet to the master bedroom fixed a flaw in traffic flow and provided more opportunities for storage in the bath.

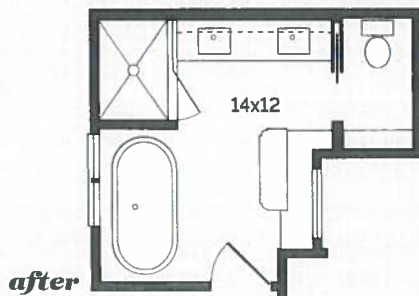
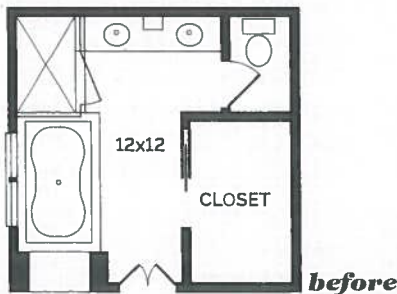

product pick

18-inch Opaque Glass
Moravian Star
Pendant, \$473
circaighting.com

