

Better Homes and Gardens Special Interest Publications

# KITCHEN

## AND BATH IDEAS

Refrigerator  
Buying  
Guide

p. 27

# Get Inspired!

## 17 Fresh Looks

How to Update  
a Basic Bath p. 130

# 79 EXPERT TIPS:

- Add Color Where It Counts
- Customize Your Island
- Create an Eat-In Kitchen

April 2012  
Display until April 10



\$5.99 U.S.

#G SIP Purple Checkout



Cheery ocher cabinets and a large blue island bring the colors—and the feel—of sun and sky into the room on even the gloomiest days.





cucina

A FAMILY  
CELEBRATES  
TOGETHERNESS IN  
A KITCHEN FILLED  
WITH WARMTH,  
COLOR, AND  
CHARACTER.

# happy days



**WHAT'S YOUR COLOR PERSONALITY?**

Discover what color speaks to your soul with our fun interactive quiz. [BHG.com/kbiquiz](http://BHG.com/kbiquiz)







**W**armth floods this cozy kitchen and family room even on Seattle's grayest, most indifferent afternoons, gleaming red and gold from cabinet niches and windows that overlook a garden.

Owners Betina Simmons and Ian Blaine have long loved the 1920s Tudor-style home, which they share with their two young sons. They were less enamored of the small, confining spaces of the original kitchen and dining room, however, so they sought a renovation that would open up the rooms and, as Betina says, "respect the bones and integrity of the house while modernizing it for our lives." Having spent many childhood summers visiting family in Denmark, Betina also craved the spirit of what Danes call *hygge*, an untranslatable word that describes a deliciously intimate coziness, fellowship, and warmth. "Simplicity and living well are also often used to describe the idea of *hygge*," she says.

With the help of designer Sharyn Wooten, Betina found exactly what she wanted. In fact, she says, "the room has become so cozy, the rest of the house has become a drop zone: Everyone takes

**OPPOSITE:** Custom-designed counter-level cabinetry provides storage while leaving wall space for windows. **ABOVE:** A white farmhouse sink and screen inserts on the doors below break up the look of the lower cabinets. Windows that reach down to the countertop give the homeowners full views of their garden and their children playing outdoors.





cucina

WOLF





off their coat and heads straight to the kitchen.” Wooten and Betina collaborated closely throughout the remodel, which added 300 square feet and a deck to the existing structure. Windows, designed to match those in the rest of the house, allow light to pour into the kitchen while providing a view of the couple’s beloved garden—and of their sons, who spend much of their free time playing there. The result, in the *hygge* spirit, is that even when not in the same room, parents and children can still feel close together.

Such details, both aesthetic and practical, take a starring role in the success of this kitchen. A neutral, classic palette of bright white walls, black soapstone counters, dark-stained floors, and golden fir detailing and cabinetry renders an ideal backdrop for bright bursts of color from Betina’s vibrant dishware collection, proudly displayed on open shelving. Other touches reflect the sunny primary shades Betina and Ian favor. “Sharyn did a wonderful job marrying our love of color and whimsy,” Betina says. “Color can help set the tone in a space, and I want our home to feel happy and inviting.”

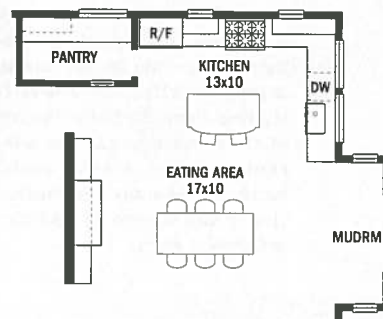

**OPPOSITE:** Mini white tiles on the backsplash give a nod to traditional 3×6-inch subway tile. The smaller size offers more texture. **ABOVE LEFT:** Countertop cabinets store oft-used items. **ABOVE:** Baking supplies slide easily in and out of the cabinets in the island, ready for use.





**OPPOSITE:** A built-in wall unit showcases special pieces from homeowner Betina Simmons' dishware collection. **ABOVE:** Open shelves keep Betina's library of cookbooks, as well as a few choice bottles of wine, easily at hand. **ABOVE RIGHT:** Galvanized chairs and barstools add an industrial edge.

The large windows that brighten the room also take up wall space ordinarily given over to cabinetry, so Wooten added a pantry where living room and kitchen meet. For Betina, an avid cook, the extra storage was crucial: The pantry is where she now keeps small appliances and large cookware. Electrical outlets along the pantry counter allow her to do much of her food prep there while maintaining her cherished garden view.

"I love the space," Ian says. "It connects cooking, dining, indoors and out. Most of all, it matches the way we live—with family and friends together around a good meal." **KBI**  
RESOURCES BEGIN ON PAGE 134.

## Takeaways

- 1** Harmonies of red, yellow, and blue are simple yet set a cheerful tone.
- 2** A roomy pantry adds storage and prep space without blocking the view.
- 3** Strategically placed windows, even on interior walls, invite in more natural light.
- 4** Classic millwork combined with contemporary, industrial designs creates a fresh look.





Color can help set the tone in a space, and I want our home to feel happy and inviting.

Betina Simmons  
homeowner