

Sunset

LIVING IN THE WEST | HOME | TRAVEL | FOOD | GARDEN

Comfort food favorites

Chicken potpie, beef-bacon chili, easy sausage lasagna, and more

Discover the best of Mt. Hood

Create a spa bath retreat

Top 10 winter weekends, from B.C. to Arizona

Grow the new no-fail roses

JANUARY 2007

\$4.99US \$6.50CAN





Rooms that reflect the natural world—through color, texture, and light—help you feel connected to the earth

Use color to soothe

A small space can be just as restorative as a large one—and color is the main ingredient for setting a peaceful mood. In Brian and Amy Fleisher's bungalow bathroom in Seattle, the mix of materials is limited to two colors: cool blue (which is calming and evokes natural elements) and warm cream (which suggests coziness and comfort). The effect is the visual equivalent of a long, cool drink of water.

Soothing hues and clean lines result in a room that seems larger than its roughly 6- by 9-foot area. The blue tint of the frosted-glass shower surround stays in step with the wall color, while the translucency of the glass allows light into the shower and adds to the open feel. Reflective and high-gloss materials—like the off-white subway tiles on the vanity backsplash and shower wall—further amplify natural light.

Making room for storage keeps clutter at bay. Opposite the shower in this bathroom, a low row of open shelving (carved from unused space in the adjacent, low-pitched attic) makes a handy spot to store towels. Keeping accessories—like faucets, cabinet pulls, towel rings, and mirrors—simple creates a visually restful scene and prevents small elements from upstaging the overall mood of the room.

INFO Design: Anna Labbee, J.A.S. Design-Build, Seattle (www.jasdesignbuild.com or 206/547-6242). Resources: See page 121. **>70**

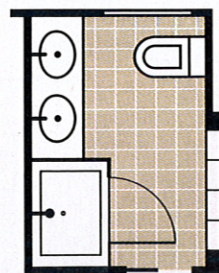

CLOCKWISE FROM TOP LEFT Chrome towel rings, unadorned mirrors, and other minimal accents add to the peaceful mood; the half-wall in the shower creates the perfect shelf for pampering products; soft gray and white towels and neutral-toned bath accessories meld with the overall palette.