

# This Old House

Best-ever  
curb appeal  
**before and  
afters**

p. 76

## 52 Quick Fix-it Tricks

> remodeling money savers  
how-to problem solvers

> DIY shortcuts

**cottage  
kitchen  
design  
secrets**

p. 50

Give grout a  
like-new look  
p. 94

Keep cupboards  
from falling open  
p. 91

Spiff up  
stainless steel  
with WD-40  
p. 94

**PLUS**

27 great  
garage-door  
upgrades

The easiest way  
to strip wallpaper

Foolproof  
guide to glue

MARCH 2011  
THISOLDHOUSE.COM

\$4.99US \$5.99CAN



0 70989 10160 9

03>



# Period style, up-to-date function

Relocating a kitchen allows for more space and light; attention to detail gives it an inviting vintage look By DEBORAH BALDWIN + Photographs by ALEX HAYDEN

When two people undertake a major redo, some negotiating is required. Vance Martin and Andrea Chin, owners of a 1909 house in Seattle, shared a vision of a colorful kitchen opening onto a porch. But he wanted a wood floor and cabinets with clear glass fronts, while she wanted no-fuss flooring and less transparency. They compromised with pale linoleum and seeded glass. Working with designer Kim Clements, they negotiated other challenges, too, including the missing joists found while poking under the floor. When a wall came down—as part of the scheme to have the kitchen and the family room trade places—Clements realized ceiling beams had to go back up in a convincing old-house way. Details like arches trimmed to match ones on the porch also make the new space “feel like it has a heritage,” she says—with amenities, of course, including a gas line threaded outside to feed Vance’s grill. The redo’s success reflects “a great partnership,” he says, and on that, the whole family agrees.

**before** The hodgepodge had only two keepers: the range and the fridge. **after** Now in a new spot, the kitchen is larger and more family-friendly. From left: Lily, then 14; Abby, 17; Andrea; and Vance.



{ before }



## before+after: kitchen

→ The existing range and hood are now complemented by a stainless-steel backsplash, soapstone countertops, and cabinets neatly finished with a display shelf and seeded-glass panels.

↓ The ornamented arch over the eating nook repeats porch details and frames a view of the dining room's coffered ceiling. Paint: C2 Paint's African Purple (hall) and Tapestry (bench); Rust-Oleum's Deep Blue (chairs)



## before

At 160 square feet, the kitchen had room for a table but lacked storage, prep space, and style.

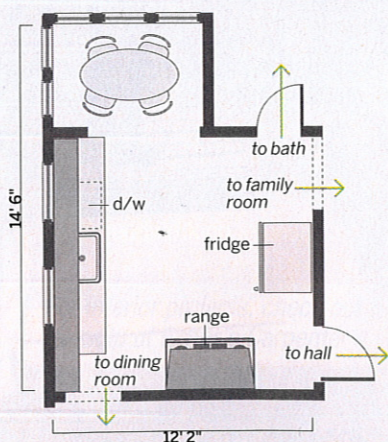

## after

Relocated, expanded to 263 square feet, and joined to a porch, the space is sunnier, and big enough for an eating nook, an island—and plenty of family and friends.

**3. Added oversize windows,** a sliding glass door, and a row of leaded panes to bring in lots of light, even in winter.

**1. Swapped places** with the family room and annexed part of the hall to gain light, space, and porch access.

**2. Placed an island** at the center for food prep and socializing.

**4. Flanked the range** with countertops and cabinets for lots more storage and prep space.

**5. Built in an eating nook,** a pantry, and a sight line to the new dining room for better flow and function.

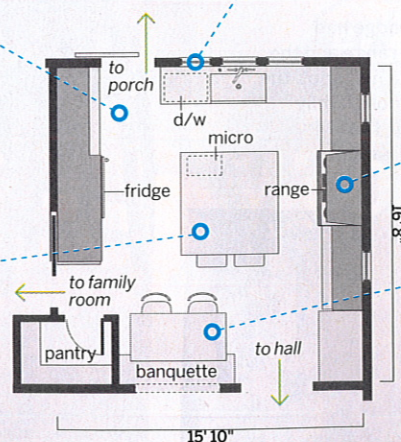





↑ **A magnetic chalkboard** near the entry to the family room serves as scribble pad and message center. Magnetic chalkboard: PBS Supply. Light fixtures: Rejuvenation. Floor: Forbo Marmoleum

→ **Oil-rubbed bronze** hinges, latches, and pulls evoke 1920s kitchens; oversize subway tile freshens the look. Hardware: Rejuvenation. Paint: C2 Paint's Chamomile (upper cabinets) and Cheetah (base cabinets)



↓ **The walnut-topped island** holds cookbook shelves on one side and a microwave on the other. Paint: C2 Paint's Tapestry (island) and Gallery White (walls)



↑ **A coffered ceiling** was built by boxing out and trimming beams for a Craftsman-style look.

## show us your remodel

Your kitchen, bath, or other renovation might appear in our upcoming reader-created issue. Post entries to [thisoldhouse.com/yourTOH](http://thisoldhouse.com/yourTOH)